

Copyright Reserved

The Contractor shall verify and be responsible for all dimensions. DO NOT scale the drawing - any errors or omissions shall be reported to Stantec without delay.
The Copyrights to all designs and drawings are the property of Stantec. Reproduction or use for any purpose other than that authorized by Stantec is forbidden.

Consultants

Plisga & Day Land Surveyors (Surveyor)
72 Main Street
Bangor, Maine 04401

Notes

CONSTRUCTION SEQUENCE

LEGEND	
DAY (COLORS VARY)	
NIGHT (COLORS VARY)	

PHASE		DURATION	4/4/22	4/11/22	4/18/22	4/25/22	5/2/22	5/9/22	5/16/22	5/23/22	5/30/22	6/6/22	6/13/22	6/20/22	6/27/22	7/4/22	7/11/22	7/18/22	7/25/22	8/1/22	8/8/22	8/15/22
MOBILIZATION		14D																				
MOBILIZATION/LAYOUT		7N																				
PHASE 1A		56D																				
PHASE 1B		35D																				
PHASE 1C		35D																				
PHASE 2A		21D																				
PHASE 2B		21D																				
PHASE 3A		14N																				
PHASE 3B		14N																				
PHASE 4A/4B (GROOVING)		17N																				
PHASE 5A/5B (FINAL MARKINGS)		5N																				
PHASE 5B (GROOVING)		3N																				
PHASE 6 (TWA/C)*		10N																				
HR = HOURS D = DAYS N = NIGHTS		*PHASE 6 TO BE COORDINATED WITH AIRPORT OPERATIONS																				
		1 2 3 4 5 6 7 8 9 10 11 12 13 14 15 16 17 18 19 20 21 22 23 24 25 26 27 28 29 30 31 32 33 34 35 36 37 38 39 40 41 42 43 44 45 46 47 48 49 50 51 52 53 54 55 56																				

WORK SCHEDULE

WORK WILL BE ALLOWED TO PROGRESS CONTINUOUSLY 7 DAYS/WEEK. RUNWAY CLOSURE AND REOPENING DATES ESTABLISHED IN THE SCHEDULE ABOVE MUST BE ADHERED TO.

56 DAY CONTINUOUS RUNWAY 11-29 CLOSURE IS DEFINED AS A CONTINUOUS CLOSURE OF RUNWAY 11-29 THAT PROHIBITS ALL LANDING, TAKE-OFF, AND TAXIING OPERATIONS FOR RUNWAY 11 AND 29. THE CONTRACTOR SHALL BE PREPARED TO START ON APRIL 18, 2022, AND ALL WORK WITH THE EXCEPTION OF GROOVING AND FINAL MARKINGS SHALL BE COMPLETE, AND RUNWAY REOPENED BY JUNE 13, 2022 AT 5:45AM.

NIGHTLY RUNWAY CLOSURES ARE DEFINED AS NIGHTLY CLOSURES OF RUNWAY 11-29 AND/OR RUNWAY 18-36 FROM 10:30PM ON ONE DAY TO 5:45AM THE FOLLOWING DAY. LANDING AND TAKE-OFF OPERATIONS FOR THE RUNWAYS ARE PROHIBITED DURING THIS TIME PERIOD. RUNWAY OPERATIONS WILL BE UN-RESTRICTED FROM 5:45AM TO 10:30PM.

- RUNWAYS SHALL BE CLEAN OF ALL DEBRIS/FOD, CONSTRUCTION EQUIPMENT, AND OPEN/AVAILABLE FOR REGULAR AIRPORT OPERATIONS (LANDING/TAKEOFF/TAXI) BY 5:45AM EACH DAY.
- FINAL MARKINGS MUST BE COMPLETED NIGHTLY BASED ON WIND/WEATHER CONDITIONS. ANTICIPATED NIGHT TIME HOURS FOR FINAL MARKINGS, AND GROOVING ARE BETWEEN 10:30PM AND 5:45AM OR AS APPROVED BY AIRPORT OPERATIONS THROUGH THE RPR.
- DURING THE 7-HOUR AND 15-MINUTE LONG NIGHTLY RUNWAY CLOSURES, THE CONTRACTOR SHALL SCHEDULE THEIR FORCES SUCH THAT RUNWAY 18-36 AND/OR RUNWAY 11-29 MUST BE REOPENED TO AIRCRAFT TRAFFIC BY 5:45AM. THIS REQUIRES ALL SURFACES WITH THE RUNWAYS TO BE MILLED OR REMOVED EACH NIGHT TO AN AREA THAT CAN BE RE-PAVED TO FINISHED GRADE DURING THE SAME NIGHT SHIFT, THIS ALSO REQUIRES THAT ALL CONTRACTOR'S EQUIPMENT/ MATERIALS BE REMOVED FROM WITHIN THE WORK LIMITS AT THE END OF EACH WORK SHIFT AND ALL PAVED AREAS MUST BE SWEEPED CLEAN OF ALL DEBRIS TO THE RPR'S AND AIRPORT OPERATIONS STAFF'S SATISFACTION BEFORE THE CONTRACTOR VACATES THE NIGHTLY WORK AREA AT THE END OF THE SHIFT. ALSO, THE SAFETY AREAS SHALL BE GRADED IN CONFORMANCE TO FAA STANDARDS BEFORE THE RUNWAYS ARE REOPENED. ALL REQUIRED TEMPORARY PAVEMENT MARKINGS MUST BE APPLIED ON RUNWAYS BEFORE THEY CAN BE REOPENED. ALL REQUIRED RUNWAY EDGE LIGHTING CIRCUITS MUST BE OPERATIONAL AT THE END OF EACH WORK SHIFT WHEN THE RESPECTIVE RUNWAY IS BEING REOPENED.

NIGHT WORK IS DEFINED AS A CONTINUOUS 7 HOUR AND 15 MINUTE CLOSURE FROM 10:30PM TO 5:45AM.

PHASES 1B AND 2B MAY NOT BE CONSTRUCTED CONCURRENTLY. CONTRACTOR SHALL MAINTAIN AIRCRAFT ACCESS TO/FROM BOTH ENDS OF RUNWAY 18-36 AT ALL TIMES WHEN IN USE.

GROOVING AND FINAL MARKINGS
GROOVING IS SPLIT INTO TWO PHASES, 4A & 4B, TO MAINTAIN CONSTANT ACCESS TO RUNWAY 18-36 WHEN IN USE. FINAL MARKINGS ARE SPLIT INTO TWO PHASES, 5A & 5B, TO MINIMIZE THE CLOSURE DURATION OF RUNWAY 18-36. REFER TO DRAWINGS G-107 - G-110. BOTH RUNWAYS WILL BE CLOSED AND THE PHASE 5B CLOSURE SET UP WILL BE USED FOR GROOVING WITHIN THE RUNWAY 11-29 AND RUNWAY 18-36 INTERSECTION.

PHASING NOTES

- ALL PROJECT COMPONENTS SHALL BE COMPLETED WITHIN **70 CONTINUOUS CALENDAR DAYS** FROM APRIL 4, 2022 TO 5:45AM ON JUNE 13, 2022, & the **21 ADDITIONAL NIGHTS** INDICATED ABOVE BETWEEN JULY 11, 2022 & AUGUST 5, 2022.
- PHASING SHALL PROGRESS ACCORDING TO THE SCHEDULE ABOVE UNLESS OTHERWISE APPROVED/DIRECTED BY AIRPORT OPERATIONS THROUGH THE RPR. UNLESS OTHERWISE NOTED, CONSTRUCTION MAY PROGRESS CONTINUOUSLY 24 HOURS/DAY OR AS NOTED UNTIL COMPLETION AND ACCEPTANCE.
- THE AIRPORT RESERVES THE RIGHT TO ADJUST PHASE ORDER AND/OR PHASE LIMITS, ON AN AS-NEEDED BASIS, AS DICTATED BY WIND AND WEATHER CONDITIONS, AND TO ACCOMMODATE SAFE AND EFFICIENT AIRPORT OPERATIONS AT NO ADDITIONAL COMPENSATION TO THE CONTRACTOR. THE CONTRACTOR SHOULD ASSUME THAT ALL MILLINGS WILL LEAVE AIRPORT PROPERTY AS THEY ARE GENERATED, OR BE STOCKPILED IN DESIGNATED LOCATIONS.
- THE CONTRACTOR SHALL BE PREPARED TO PROVIDE SUFFICIENT PERSONNEL AND EQUIPMENT TO PERFORM ALL PROPOSED WORK IN A MANNER THAT WILL ACHIEVE THE QUALITY AND PRODUCTION RATE TO COMPLETE THE PROJECT AS SCHEDULED HEREIN.
- LIGHTING ASSOCIATED WITH CLOSED PORTIONS OF RUNWAYS AND TAXIWAYS SHALL BE DISCONNECTED OR COVERED DURING EACH PHASE AS DIRECTED/APPROVED BY THE RPR AND AIRPORT OPERATIONS IN ADVANCE. THE USE OF TEMPORARY JUMPERS SHOULD BE ANTICIPATED TO MAINTAIN PORTIONS OF EXISTING CIRCUITS.
- TEMPORARY CIRCUIT CONNECTIONS FOR PHASING SHALL BE CONSIDERED INCIDENTAL TO THE VARIOUS PROJECT ITEMS.
- FINAL MARKING APPLICATION SHALL BE APPLIED 30 DAYS AFTER PAVEMENT PLACEMENT AND AFTER GROOVING IS COMPLETED, PRIOR TO FINAL ACCEPTANCE WITH APPROVAL OF THE RPR, UNLESS OTHERWISE APPROVED BY THE RPR.
- ALL WORK WITHIN THE SPECIFIED PROJECT LIMITS EXCEPT FOR GROOVING, AND FINAL MARKINGS MUST BE COMPLETED WITHIN 56 CALENDAR DAYS FROM THE RUNWAY CLOSURE START DATE.

DETAILED PHASING

REFER TO G-101 - G110 DRAWINGS FOR DETAILS OF INDIVIDUAL RUNWAY PHASES (I.E. ASSOCIATED RUNWAY & TAXIWAY CLOSURES, WORK HOURS, HAUL ROUTES, TEMPORARY CIRCUITS, ETC.)

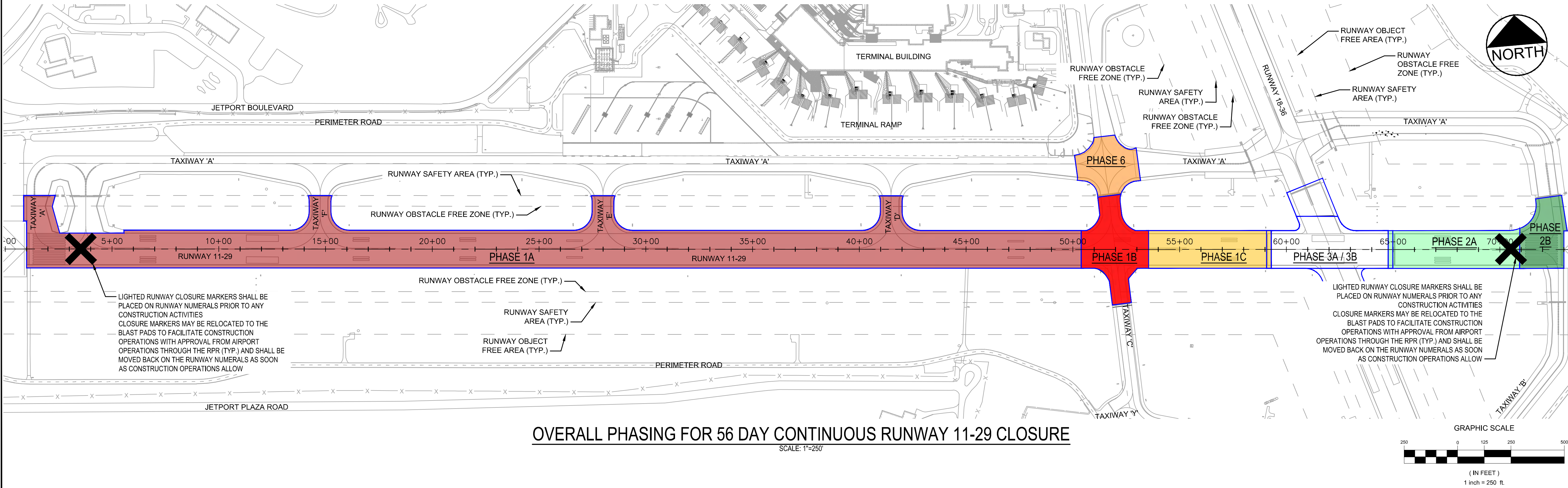

File Name: ADK DWN. DDA CHKD. ADK DSGN. NOV 2021 DATE

Permit-Seal



Client/Project

PORTLAND INTERNATIONAL JETPORT

REHABILITATE RUNWAY 11-29 (2022)

PORTLAND AND SOUTH PORTLAND, MAINE

Title

OVERALL PHASING PLAN

Project No.

179450440

Scale

AS NOTED

Sheet

G-100